

NOTE: BREAK ALL CORNERS WITH 0.015" (.38 MM) RADIUS UNLESS OTHERWISE SPECIFIED. STANDARD TOLERANCES TO APPLY UNLESS OTHERWISE SPECIFIED.

CUSTOMER <b>CAN ART STD.</b>		DIE No. <b>EH21401</b>	REV. No. <b>2</b>
DESCRIPTION <b>3/8" SCHED 40 PIPE</b>	CUSTOMER PART No.	QUOTE No. <b>21-1573-1</b>	PROPOSAL No. <b>H-42962</b>

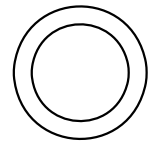
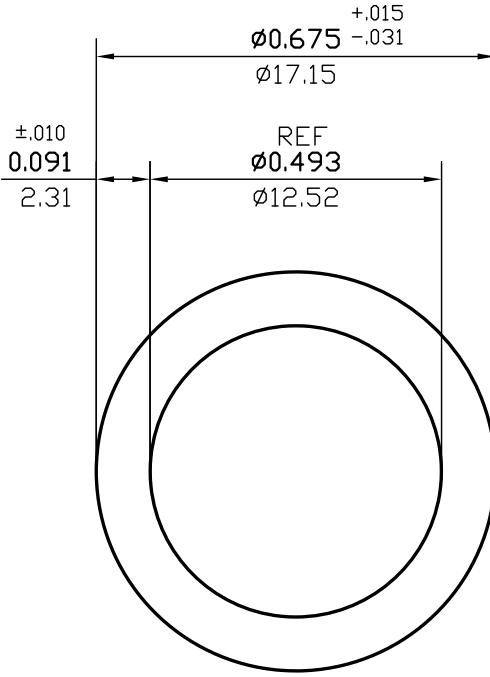

ACTUAL SIZE

WALL THICKNESS **0.091 (2.31)** EXCEPT AS SHOWN

DATE	REV	DESCRIPTION	BY
03/10/23	2	REMOVED EXPOSED SURFACES AND ALLOY	JASON
02/02/22	1	REVISED CUST NAME.	PAUL
EST.AREA	<b>0.167</b>	IN. <sup>2</sup>	EST.AREA <b>107.715</b> MM. <sup>2</sup>
EST.WT.	<b>0.197</b>	LBS/FT.	EST.WT. <b>0.293</b> KG/M.
EST.PER.	<b>3.669</b>	IN.	EST.PER. <b>93.202</b> MM.
OUT PER.	<b>2.121</b>	IN.	OUT PER. <b>53.9</b> MM.
C.C.D.	<b>0.675</b>	IN.	C.C.D. <b>17.145</b> MM.
FINISH	<b>M/F</b>		ALLOY
CKD BY	FACTOR <b>19</b>	SCALE <b>3:1</b>	DWN BY <b>P.M.</b> DATE <b>11/15/2021</b>

# CAN ART

ALUMINUM EXTRUSION L.P.

85 PARKSHORE DRIVE  
 BRAMPTON, ONT L6T 5M1  
 TEL. NO. (905) 791-1464  
 FAX NO. (905) 791-9151  
 WEB: www.canart.com

THIS DRAWING IS NOT NECESSARILY A COPY OF YOUR ORIGINAL. PLEASE APPROVE DIMENSIONS AND TOLERANCES INDICATED. CAN ART ASSUMES NO RESPONSIBILITY EITHER TECHNICAL OR LEGAL FOR HAVING THIS SHAPE MADE. THE CUSTOMER AGREES TO FULLY PROTECT CAN ART ALUMINUM FROM CLAIMS OF OTHERS RESULTING FROM THIS SHAPE.

SIGNED: \_\_\_\_\_ DATE: \_\_\_\_\_